

## SBS Details: D1.7.2-2 Parapets & Copings (Low Parapet – Unsupported)

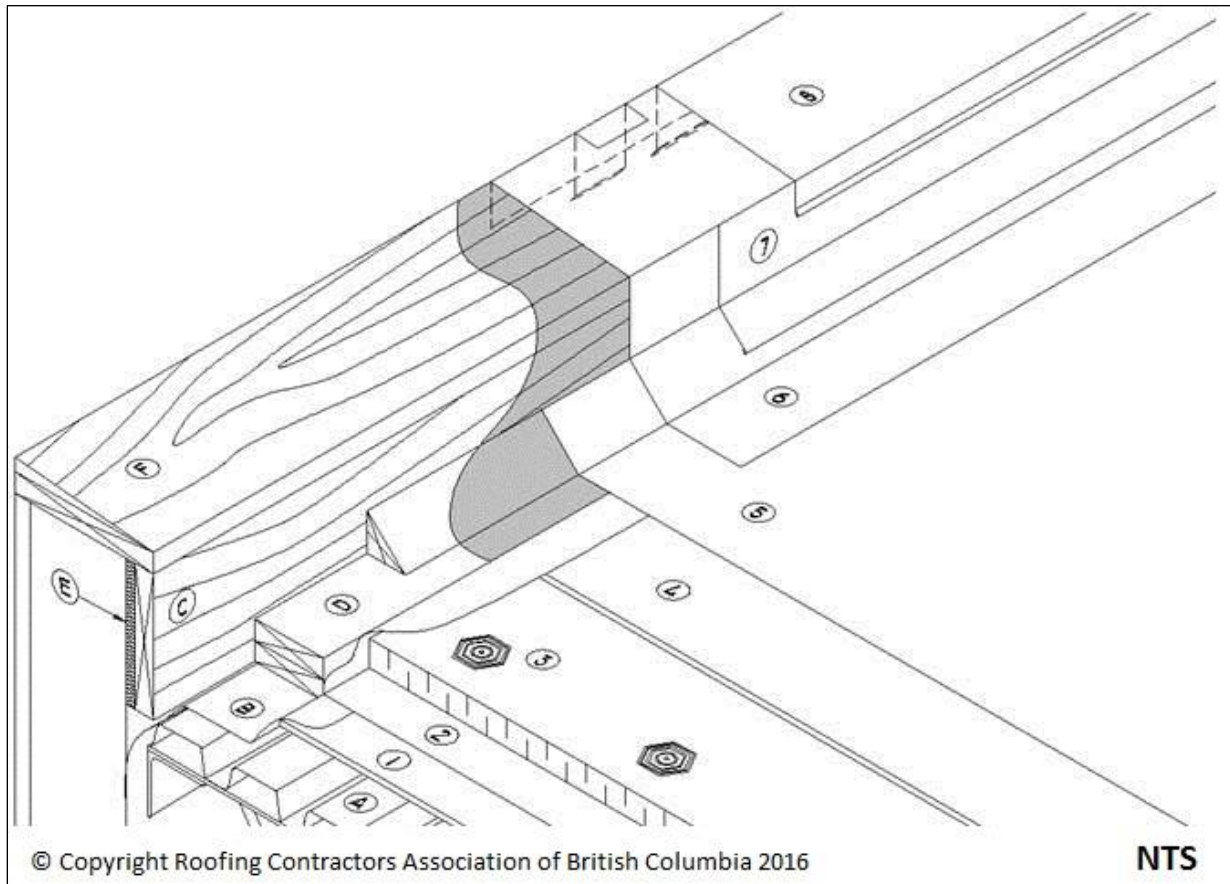

**Notice to reader:** Drawing for illustration purposes only. Consult the RoofStar Guarantee Standards for more information.

### 1 WORK INCLUDED

(1) [Gypsum Deck Overlay](#)

(2) [Vapour Retarder](#)

If required by design authority.

(3) [Insulation](#)

(4) [Insulation Overlay Board](#)

As required.

(5) [Primary Membrane and Membrane Protection](#)

(6) [Membrane Flashing](#)

Mechanically fasten to outside face of parapet blocking (F). Do not mop outside edge. At least one ply must extend over outside edge.

(7) [Metal Base Flashing](#)

Optional on flexible membrane systems. Required on assemblies using gravel ballast filter mats. See **Section 13.6 - Cap Flashings, Base Flashings and Reglets**.

(8) [Metal Cap Flashing](#)

Flashings 7 and 8 may be one piece. See Section 14. Fasten with continuous concealed clip-type fasteners **or** cladding screws evenly spaced between seams. See **Section 13.3 - Attachment**.

---

## 2 RELATED WORK BY OTHERS

(A) [Acceptable Steel Deck](#)

(B) [Air/Vapour Seal](#)

(C) [Acceptable Wall Surface](#)

(D) [Wood Blocking](#)

(E) [Sloped Wood Blocking](#)

Required over 100 mm (4") parapet width.